

FED. ROAD DIST. NO.	STATE	JOB PIECE NO.	FISCAL YEAR	SHEET NO.	TOTAL SHEETS
6	OKLA.				
DESCRIPTION		REVISIONS		DATE	

POINTS	NORTHING	EASTING
1	388755.46	1723828.62
2	388624.78	1723952.40
3	388475.03	1724084.95
4	388431.50	1724148.54
5	388443.75	1724161.73
6	388508.88	1724124.46
7	388320.67	1724214.33
8	388385.92	1724175.31
9	388398.38	1724188.30
10	388356.66	1724251.86
11	388212.31	1724390.29
12	388090.70	1724523.53

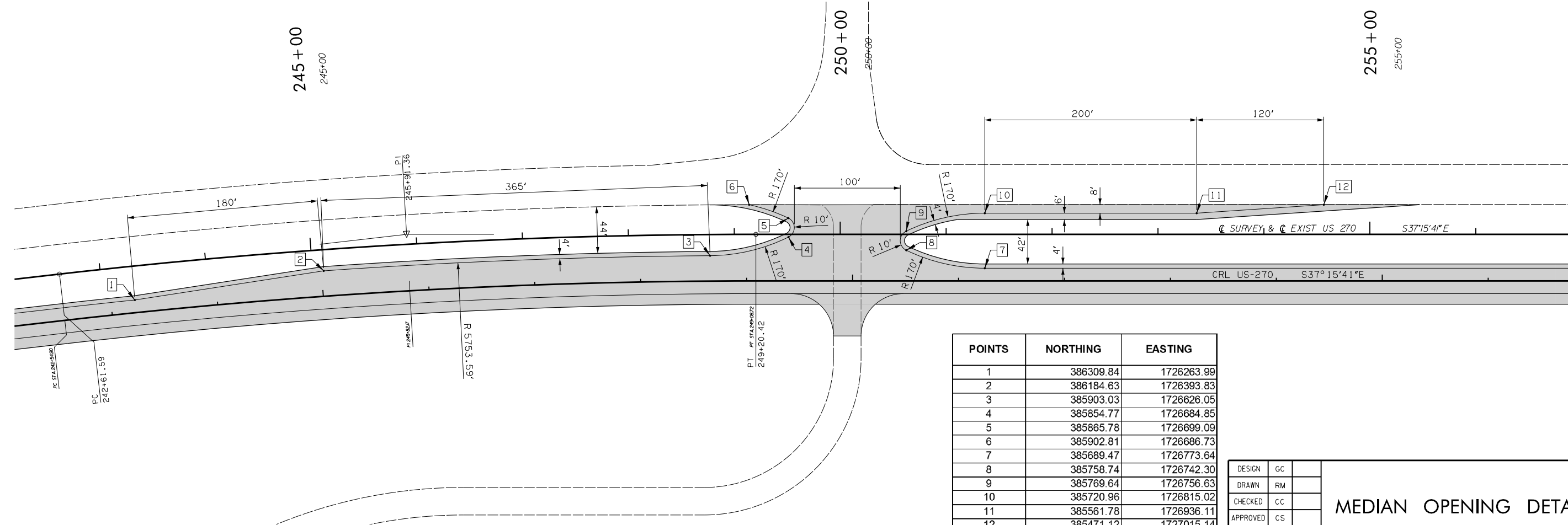
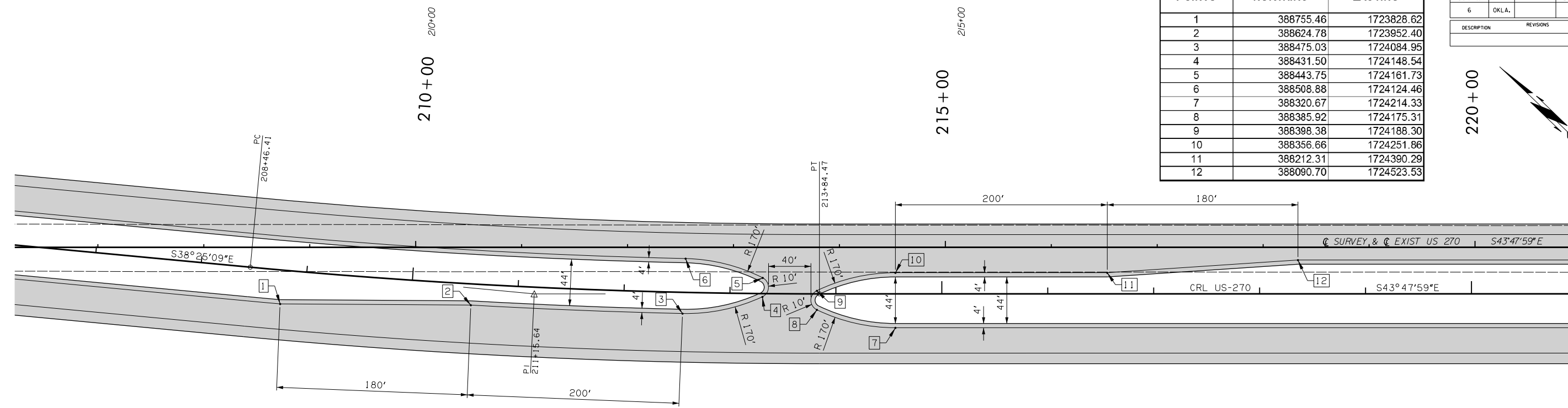

POINTS	NORTHING	EASTING
1	386309.84	1726263.99
2	386184.63	1726393.83
3	385903.03	1726626.05
4	385854.77	1726684.85
5	385865.78	1726699.09
6	385902.81	1726686.73
7	385689.47	1726773.64
8	385758.74	1726742.30
9	385769.64	1726756.63
10	385720.96	1726815.02
11	385561.78	1726936.11
12	385471.12	1727015.14

DESIGN	GC
DRAWN	RM
CHECKED	CC
APPROVED	CS
SQUAD	DEWBERRY

MEDIAN OPENING DETAILS

STATE JOB NO. 17671(34) SHEET NO. 22
DEWEY CO. US-270